

# BLOWERS ACCESSORIES

## BLIL – In-Line Filter - *vacuum*



Filters from 1 1/4" to 4" and, upon request, we design filters with flows up to 4.000 m<sup>3</sup>/h. The cartridges fitted inside the complete filters can give different types of filtration (paper, polyester, inox) lending our products high level of dust collection. Each filter is tested at 100% safety standards before and after painting.

The cartridges fitted inside the complete filters can give different types of filtration:

- Paper - **standard version** - [PA] 5-7 µm \*
- Polyester [PO] 25 µm \*
- Stainless steel [SS] 30 µm \*
- Stainless steel [SS] 60 µm \*

This series of filters is widely used in motors for: Machine Tools, Earth Movers, Compressors and Combustion Engines. They are available with threaded connections, filters with special connections can be supplied upon request. The filter element made of high quality treated paper, and a filtration degree of 5 - 7 µm, assures maximum protection.

Other available filter elements: polyester (25 µm) or stainless steel (30 or 60 µm).

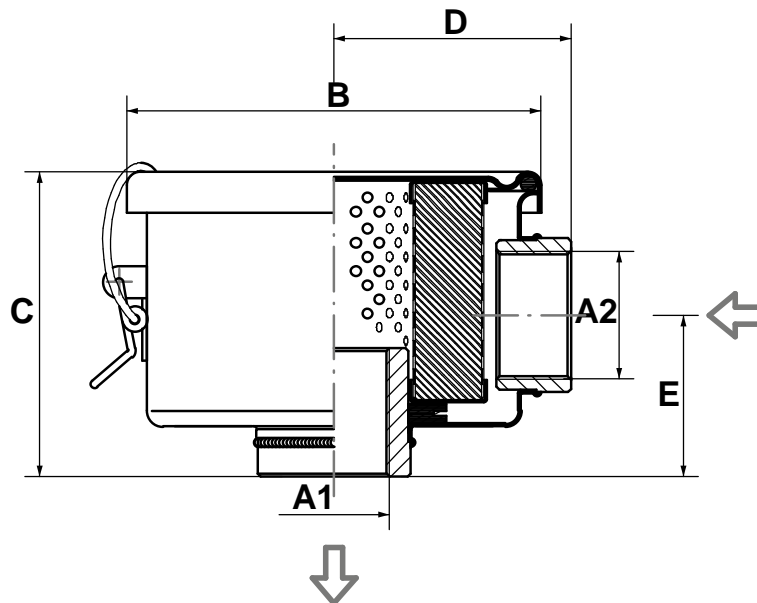

| FILTER CODE * | Capacity [m <sup>3</sup> /h] | A1         | A2  | B     | C     | D   | E         | CARTRIDGE CODE – BLSFIL_____ |                 |           |
|---------------|------------------------------|------------|-----|-------|-------|-----|-----------|------------------------------|-----------------|-----------|
|               |                              |            |     |       |       |     |           | Paper - PA                   | Polyester - PO  | INOX – SS |
| BLIL032PA007  | 150                          | 1 1/4 BSPP | 176 | 161   | 100   | 85  | _032PA007 | _032PO025                    | _032SS030 / 060 |           |
| BLIL040PA007  | 200                          | 1 1/2 BSPP | 176 | 196   | 98    | 110 | _040PA007 | _040PO025                    | _040SS030 / 060 |           |
| BLIL050PA007  | 320                          | 2" BSPP    | 199 | 256   | 113.5 | 129 | _050PA007 | _050PO025                    | _050SS030 / 060 |           |
| BLIL065PA007  | 340                          | 2 1/2 BSPP | 199 | 258.5 | 113.5 | 129 | _065PA007 | _065PO025                    | -               |           |
| BLIL080PA007  | -                            | 3" BSPP    | -   | -     | -     | -   | _080PA007 | _080PO025                    | -               |           |
| BLIL100PA007  | 750                          | 4" BSPP    | 308 | 336   | 166   | 202 | _100PA007 | _100PO025                    | -               |           |

\* BLIL\_PA007 is standard version. Also available (on request): BLIL\_PO025, BLIL\_SS030 and BLIL\_SS060.