

# SEAFLO®

## SUBMERSIBLE AND INLINE PUMP

### INSTALLATION MANUAL

#### Description

The Submersible Inline Pump is able to function as a flooded suction water supply pump or as an inline booster pump. It is able to pump clean water or diesel.

#### Installation

Use suitable size of hose (check outlet dia of technical data below) to connect to the pump, use adaptor when you need it.

**Note:** Ensure that the adaptors are pressed on firmly. Once fitted the adaptors cannot be removed.

Install a check valve in the pipe when there is a long run of pipe between pump and faucet.

**The In-line Booster Pump must be installed in the following ways:**

1. The position of the pump is lower than the water tank, and pump the oil or water;
2. In conjunction with:
  - a) a hand-operated pump
  - b) a foot operated pump
  - c) in-line to boost another pump

#### Notes:

- Position the In-Line Booster pump in the suction pipe between the foot pump and the water tank, not between the foot pump and faucet.
- The In-Line Booster pump is light enough to suspend in the pipework.
- The In-Line Booster Pump is a sealed unit and can be submersed in water.

#### Operation

1. As the In-Line Booster pump is not self-priming, it is necessary to prime the system with either: a hand pump, a foot pump, by gravity.
2. When fully immersed in water the inline pump is primed and gives instant delivery of water.

#### Caution

1. Do not pump water above 60°C (140°F), or below 0°C (32°F).
2. Do not pump diesel above 50°C (122°F).
3. The pump is suggested to be installed vertically. The pump outlet should be higher than the inlet, if possible.
4. The duty cycle of the pump is continuous.

#### Maintenance

To protect against damage during the winter, drain the water when the pump is not using.

[info@createflow.cz](mailto:info@createflow.cz)  
[www.createflow.cz](http://www.createflow.cz)

Create Flow s.r.o.

Tel: 00420 722 712 652

## Before usage

For efficient operation and maximum pump life, note the following points:

- In order to avoid the trapped air inside the pump and to ensure the successful priming, place the pump in water and shake for a few seconds in a horizontal or inverted position before switching the pump on. (This action should be repeated after refilling the water tank.)
- In order to avoid air leaks, securely fasten the hose connections.

## Technical data

Model	Voltage	Max Draw	Head	Flow rate	Duty Cycle	Outlet Dia	Pumping Liquid
SFSP1-G200-03B	12V	4.5A	7m/23'	200GPH	Intermittent	2/5"(11mm)&1/2"(13mm)	Water
SFSP1-G280-02A	12V	4.5A	10m/32'	280GPH	Intermittent	1/2"(13mm)	Water, Diesel
SFSP1-G280-02B							
SFSP1-G500-02A	12V	4.5A	10m/32'	500GPH	Intermittent	3/4"(20mm)	Water, Diesel
SFSP1-G500-02B							

"A" refers to with clip and 5M cable. "B" refers to with only 1M cable.

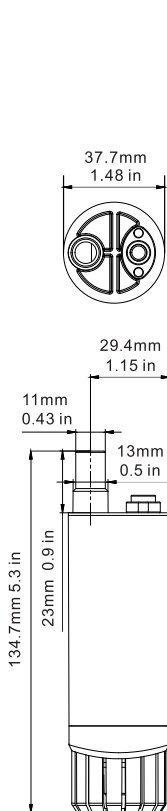

**200 GPH**

[info@createflow.cz](mailto:info@createflow.cz)  
[www.createflow.cz](http://www.createflow.cz)

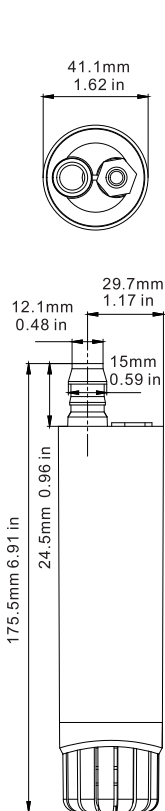

**280 GPH**

Create Flow s.r.o.

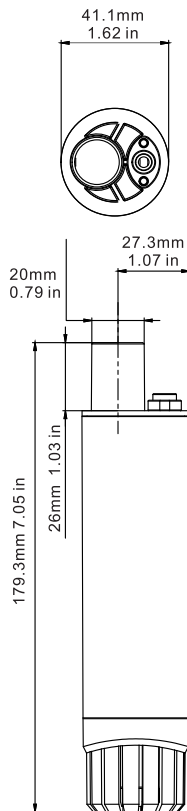

**500 GPH**

Tel: 00420 722 712 652