

# SIDE CHANNEL BLOWERS

## BL 620 002 – Double Impeller



Construction of the ring blowers fans is based on the lateral ducts principle. The blowers can operate as either exhaust or compression fans and are designed for continuous service. The device is assembled directly on the motor shaft; all the rotating parts are dynamically balanced to ensure absolute absence of vibration. Full die-cast aluminum construction for maximum sturdiness and ease of handling. The characteristics data given here refer to the handling of gas with inlet temperature of 15°C, normal density of 1,23 kg/m<sup>3</sup> and absolute pressure of 1023 mbar. Tolerance of ±10%.

Model	Freq. [Hz]	Power [kW]	Voltage [V]		Rated Current [A]		Max Airflow [m <sup>3</sup> /h]	Rated VACUUM [mbar]	Rated COMPRESSOR [mbar]	Noise [dB A]	Weight [kg]
			Δ	Y	Δ	Y					
BL62000204000	50	4	345÷415	600÷720	9.0	5.2	320	-355	375	73	53
	60	4.6	380÷480	660÷720	9.4		385	-345	315	76	
BL62000205500	50	5.5	345÷415	600÷720	13.3	7.7	320	-440	500	73	70
	60	6.3	380÷480	660÷720			380			76	
BL62000207500	50	7.5	345÷415	600÷720	16.7	9.6	320	440	570	73	74
	60	8.6	380÷480	660÷720	17.3	10.0	380	460	660	76	
BL62000204003	50	4	200÷240	345÷415	15.5	9	320	-355	375	73	53
	60	4.6	220÷275	380÷480	16.2	9	385	-345	315	76	
BL62000205503	50	5.5	200÷240	345÷415	22.8	13.3	320	-440	500	73	66
	60	6.3	220÷275	380÷480	22.8	13.3	380	-440	500	76	

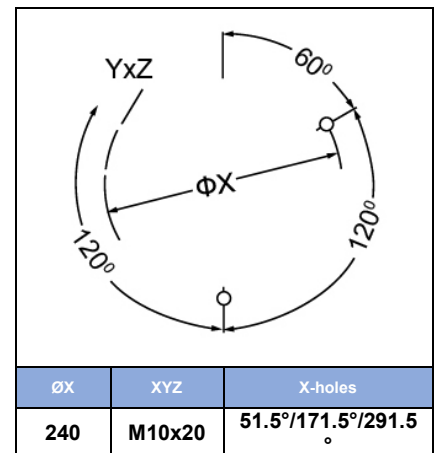
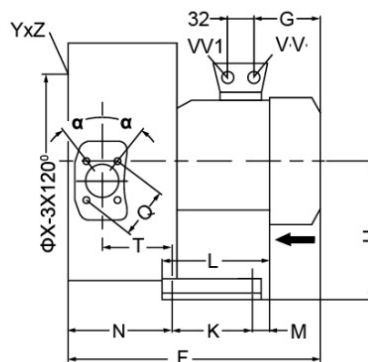
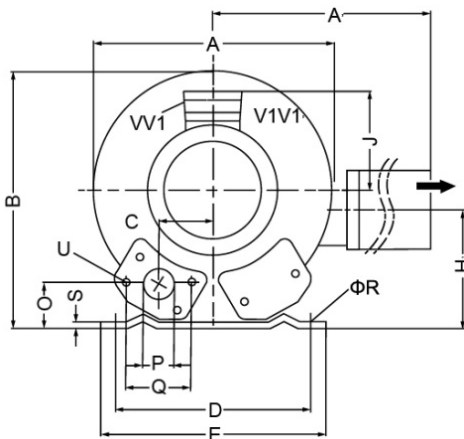
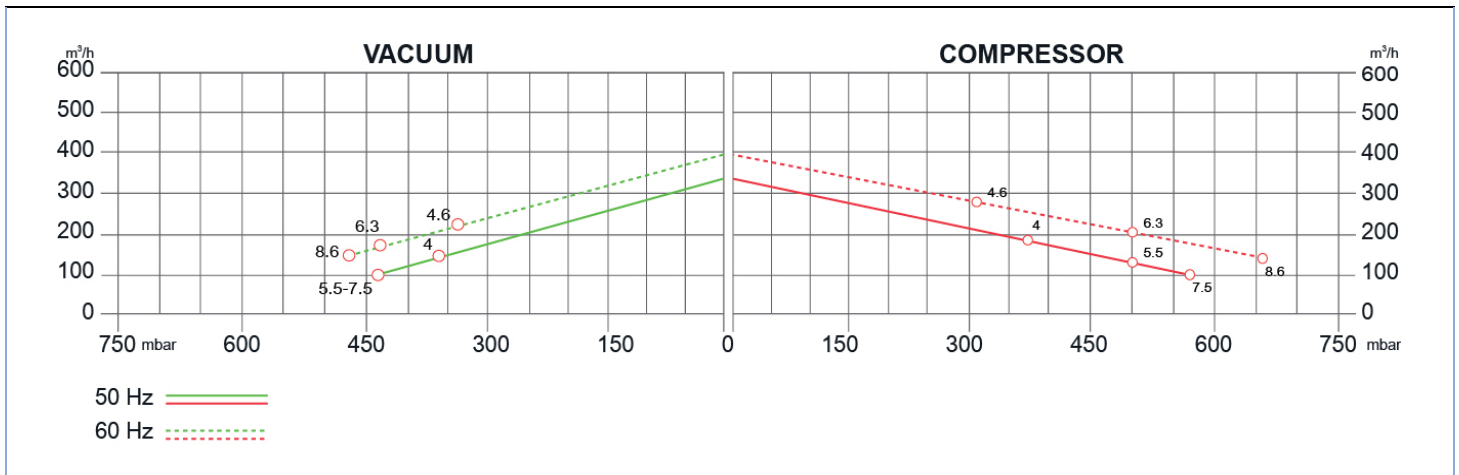

tel: +420 722 712 652

Create Flow

Your Choice,  
Our Commitment

# SIDE CHANNEL BLOWERS

## BL 620 002 – Double Impeller



MODEL	A	A'	B	C	D	E	F	G	H	H'	J	K	L	M	N	O	P	Q	ØR	S	T	U	V1	V1'	W
BL62000204000				63			526	209			148			84											
BL62000205500				154			571	226						200											
BL62000207500	426	426	410		290	325			197	162		140	180		205	53	G 2	83	15	4.5	130	M8X17	M32X1.5	M32X1.5	42
BL62000204003							526	209			167			84											
BL62000205503				63																					

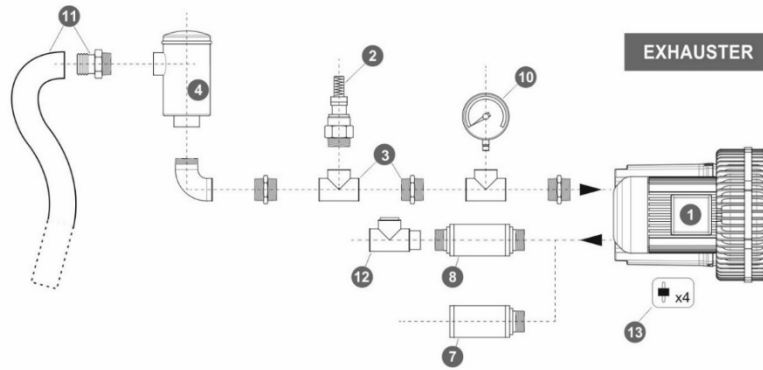

Ref. #	Description	Code
1	Side Channel Blower Double Impeller / Double Stage – 2” connection	BL 620 002_
2	Safety Valve	BLSV050AL36
3	Installation kit safety valve	BLKS05F050C
4	In-Line filter	Paper Polyester Stainless Steel 30 µ Stainless Steel 60 µ
5	Cartridge filter	BLCF050PA007
6	Filter kit	Nipple Socket
7	Final Silencer	BLFS050ZP - BLFS050ZPR
8	In-Line silencer	BLIS050
9	Indoor filter	BLIF050ZP100
10	Gauge	BLMN06306 BLVG06306
11	Sleeve + Hose clip kit	BLSH050
12	Check valve	BLCV050AL
13	Anti-vibration pins	BLAV08

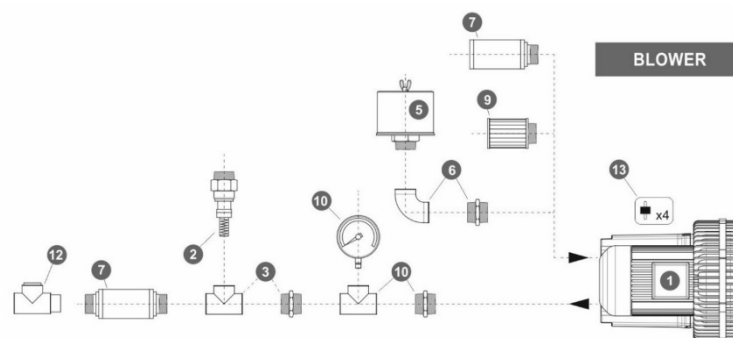

tel: +420 722 712 652

Create Flow

info@createflow.cz  
www.createflow.cz

Your Choice,  
Our Commitment